

Starlight II

Outdoor Day & Night Bullet Camera

MODEL

2-CCD-05

Day & Night color CCD camera with high sensitivity and DSP signal processing.



SONY SuperHAD II CCD for best performance

- ▶ Starlight Technology Day & Night Bullet Camera
- ▶ Adopt the latest Sony Super HAD I ICCD for improved light performance
- ▶ "State-of-the-Art" Sony 440K Pixels CCD with Remarkable 2250mV of Sensitivity
- ▶ Super BLC adjustability for the toughest back lit situations
- ▶ Advance DNR reduces video noise in low light situations coupled with virtual 3D filter
- ▶ Day / Night Setting : Camera can always remain in color or automatically shift into B/W in low light conditions
- ▶ NO problem caused by objects that reflect or absorb IR lighting sources
- ▶ LC : Light Compensation
- ▶ Built-in glass element Aspherical Auto Iris Lens with IR-Cut optional

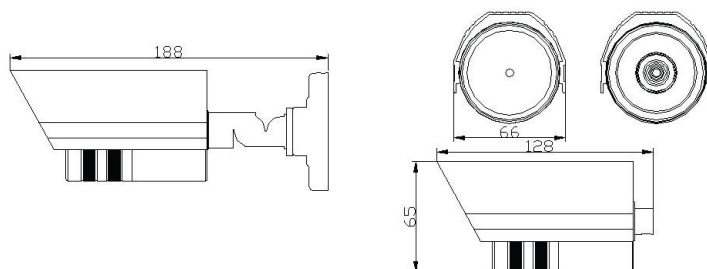

Model No.	2-CCD-05
Image Sensor	Latest Sony Super HAD II CCD Advanced Hitachi DSP with 14bit Converter
Signal	PAL or NTSC Color System
Numbers of Pixel	(H)512x(V)582 (PAL) ; (H)512x(V)492 (NTSC)
Resolution	480TV Lines
Lens	Vari-focal 4~9mm lens
Scanning	2:1 Interlace
Synch	Internal
Video out Level	1.0Vp-p/75Ω Video 0.714Vp-p Sync 0.286Vp-p
S/N	52dB(Min)/60dB(TYP)(AGC OFF)
Minimum Illumination	0.001Lux of F1.2 (IR-CUT Mode) 0.00035Lux of F1.2 (Sense UP Mode)
Gamma Correction	0.45
AGC	+18dB Max
IRIS Control	Electrical IRIS/Lens IRIS (Video Signal or DC Control)
Electrical Shutter	1/60(1/50)~1/120000 sec
Power Supply	DC 12V±1V /90mA Max.
Operating Temp.	-10°C~+50°C RH95%MAX
Dimension	Φ66* 188mm
Weight	500g

© 2008 XCam. Due to continuous product development we reserve the right to change models and specifications without prior notice.

Available from:



HIGHEST QUALITY – BEST PERFORMANCE